

Raised Quick Installation Kits **Quickie** **RAISED R**

Everything you need to plumb a storage hot water system **quickly**



Save time
on installation
with a **Quickie**



- There is a Kit to suit your state
- Installations are always done the same way
- Kits tailored to suit your needs

Quickie **RAISED R**

QUICK INSTALLATION KITS

The R&D team at AVG have developed the Quickie kit for Storage Hot Water Systems with the best interests of the Plumber in mind.

The AVG Storage Quickie Kit is the most comprehensive and versatile installation kit for storage hot water systems, on the Australian/New Zealand market. Within the Quickie Kit range there are kits to suit, Electric storage, Gas storage, Solar & Heat Pump systems.

The outstanding feature of all these kits is that they come complete with all insulation to cover not only the AVG Heating Control Valves, but also the brass fittings necessary to complete the installation. Saving the plumber substantial time and therefore money.



10 REASONS TO BUY THE AVG QUICKIE KIT

- Every thing you need in the one box - No missing parts on the job.
- Quick and Simple
- There's a Quickie kit to suit - Gas storage, Electric storage, Solar hot water systems, and Heat pumps.
- Reduces the need for thread seal tape
- Reduces the time on installations.
- Simple and Easy to Assemble - All installations are done the same.
- Flexible - Quickie kits can be modified to meet different installation requirements in various states and councils, i.e. the expansion control valve or pressure reduction valve can easily be added to the Kit
- Easily accessible filters
- Insulation - Insulation provided is UV stabilised and water resistant.
- Kits available in 15mm and 20mm.

Raised Quick Installation Kits

valve
insulation
included

TYPICAL QUICK KIT PARTS

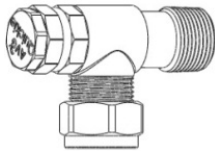

HOTWATER OUTLET x 1

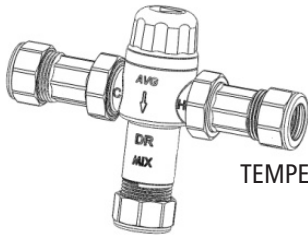

TEMPERING VALVE x 1

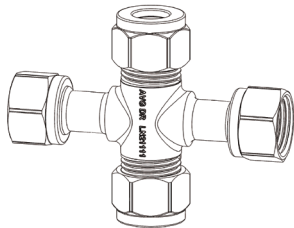

QUICKIE 4WAY x 1

FIBRE WASHER x 2

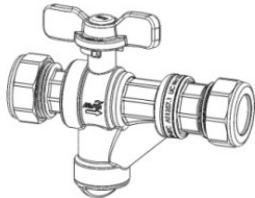

STOP TAP NON RETURN x 1

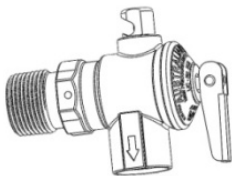

EXPANSION CONTROL x 1



OPTIONAL PLUG x 1



TR DRAIN FITTING x 1

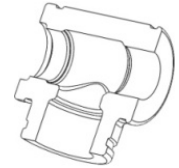

HOTWATER OUTLET GLOVE HALVES x 1 SET

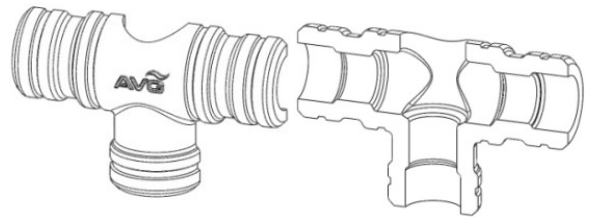

TEMPERING VALVE GLOVE HALVES x 1 SET

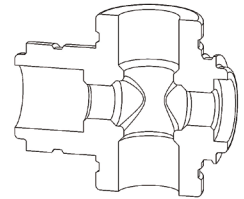
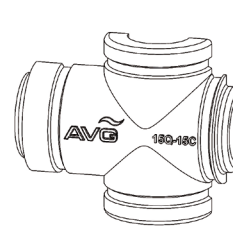

QUICKIE 4WAY GLOVE HALVES x 1 SET

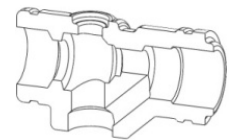

STOP TAP NON RETURN GLOVE HALVES x 1 SET

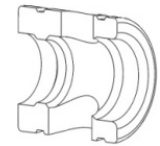

EXPANSION CONTROL GLOVE HALVES x 2 SETS
(SECOND SET FOR PTR VALVE NOT SUPPLIED)



CABLE TIE x 17

a storage hot water system quickly

Quickie **RAISED R**

Quickie R Kit

QIK15R Model

Storage 15mm (1/2") & 20mm (3/2")

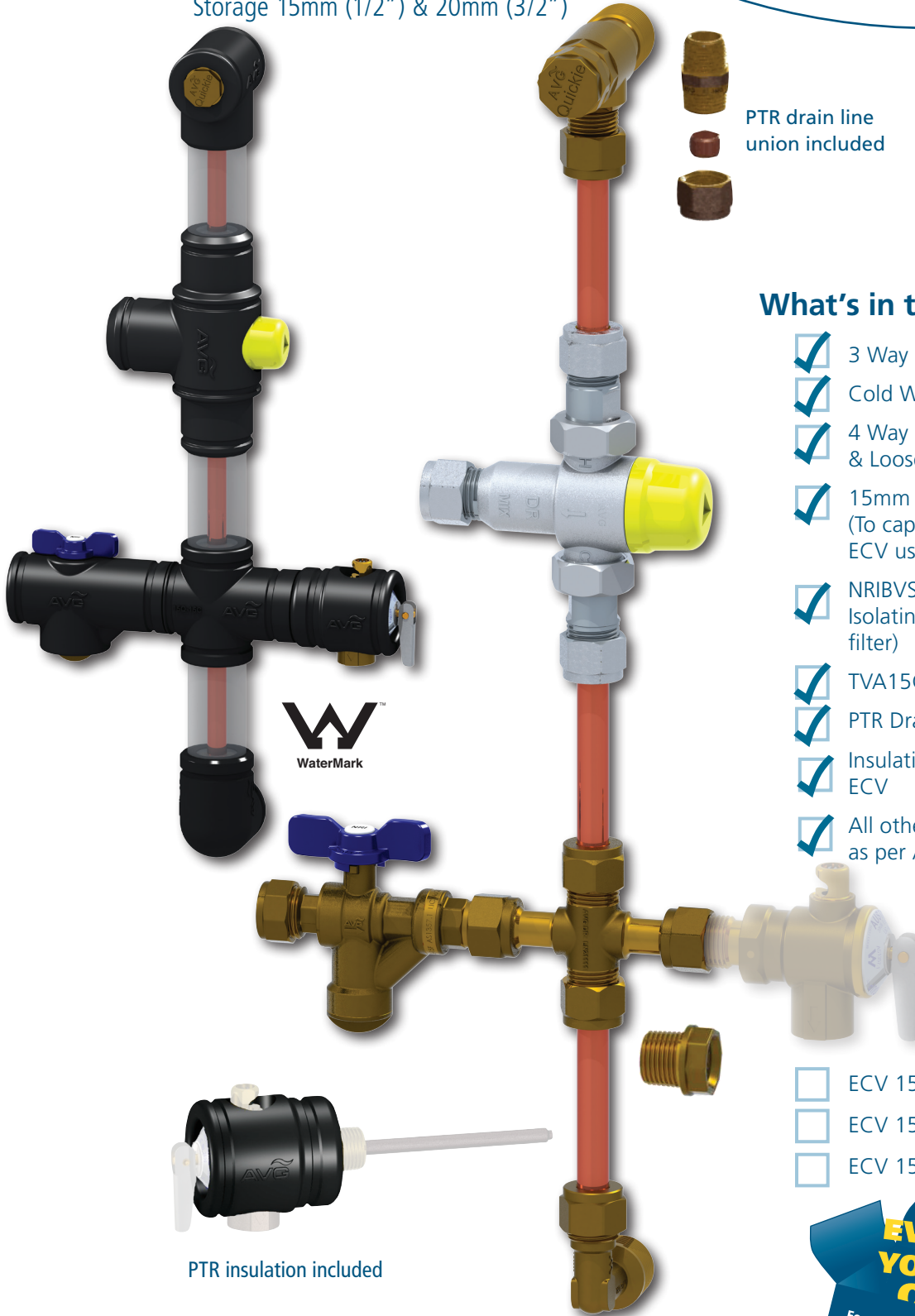

PTR drain line union included

What's in this 15mm kit:

- 3 Way Hot Water Outlet
- Cold Water Inlet Elbow
- 4 Way Cross (Compression & Loose Nut)
- 15mm Brass Plug (BSP)
(To cap off 4 way tee if no ECV used)
- NRIBVS-15C (Non Return Isolating Ball Valve with filter)
- TVA15C-*i*
- PTR Drain line union
- Insulation for both PTR & ECV
- All other relevant insulation as per AS:3500

- ECV 15/700
- ECV 15/850
- ECV 15/1200

PTR insulation included



Raised Quick Installation Kits

valve
insulation
included

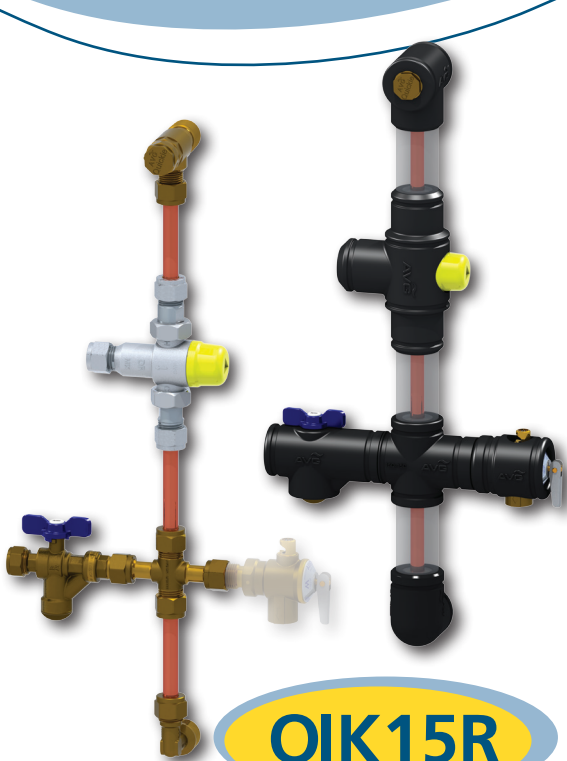

QIK15R

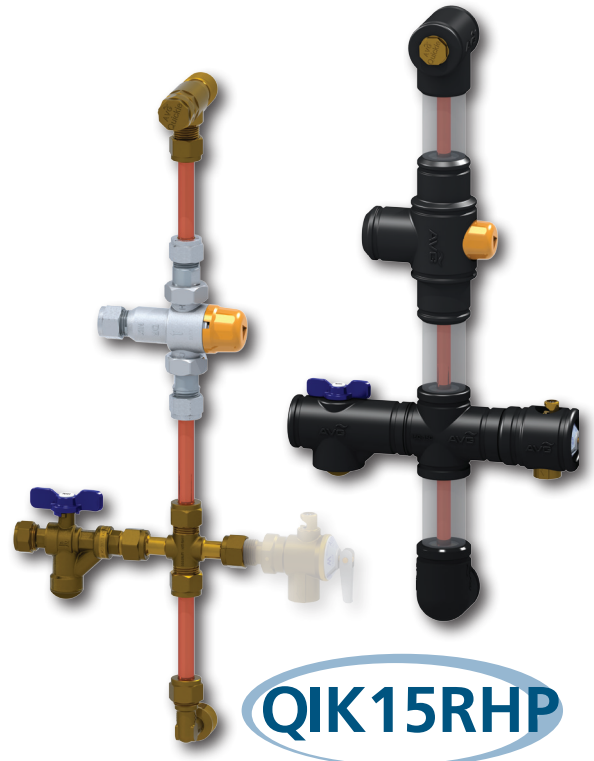

QIK15RHP



QIK15RCV

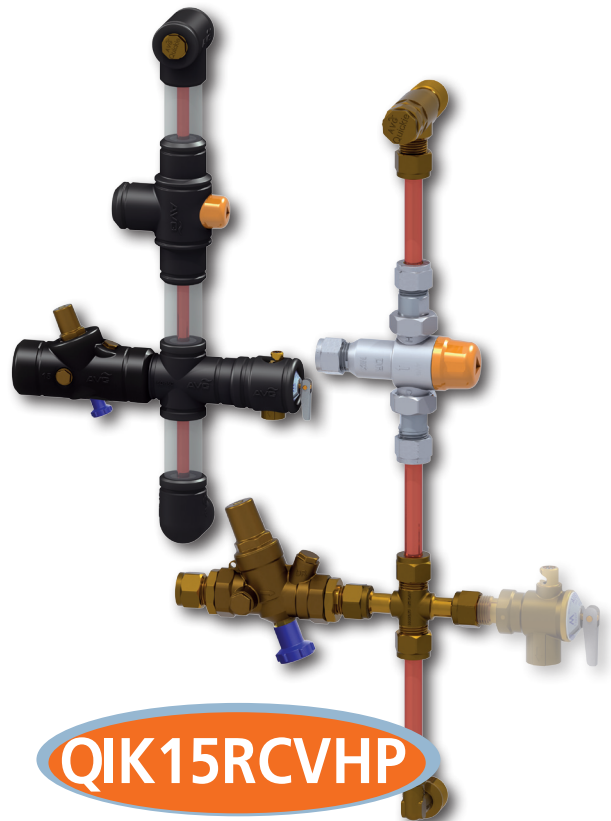

QIK15RCVHP

a storage hot water system quickly

EASY TO ASSEMBLE

1

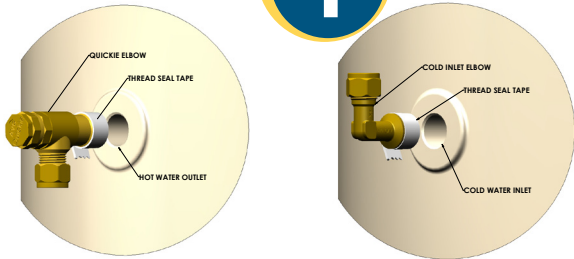

Put thread seal tape onto the tapered threads of the hot water outlet fitting with filter and the cold water inlet elbow and connect them to the water heater with the compression connection of the hot water fitting facing downwards and the compression connection of the cold water fitting facing upward.

2

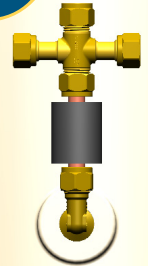

Cut the copper tube and insulation to length between the raised cr and the cold inlet fitting to suit your installatio then fit the tube and insulation then tighter into position.

3

Cut a length of copper tube to a minimum of 185mm (to achieve a minimum centre distance of 250mm between the hot water outlet centreline and the tempering valve mixed hot water outlet centreline in accordance with AS/NZS3500.4-2003 clause 8.4b Heat Traps). Fit the copper tube into the fitting and tighten.

185 MINIMUM

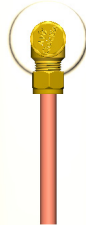

4

Cut a length of pipe insulation 45mm shorter than the copper tube and slide it onto the copper tube. Remove the hot water inlet fitting from the Tempering valve assembly and connect it to the hot water outlet copper tubing and tighten.

COPPER TUBE LENGTH MINUS 45mm

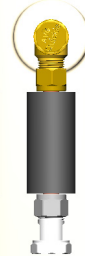

5

Re- attach the tempering valve to the hot water inlet fitting of the Tempering valve and measure the distance between the tube stop of the cold water inlet fitting of the Tempering valve and the tube stop of the raised cross. Cut a length of copper tube 3mm shorter than your measurement and cut the pipe insulation 45mm shorter.

3mm SHORTER THAN MEASURED LENGTH

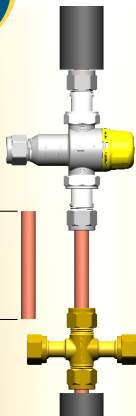

6

Unscrew the Tempering valve from the hot water inlet fitting and remove the cold inlet fitting from the Tempering valve assembly. Fit the copper tube into the cold water inlet elbow and tighten.

Tempering valve cold water inlet fitting

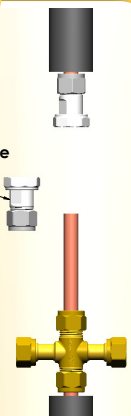

Quickie **RAISED R**

valve
insulation
included

7

Slide the pipe insulation onto the cold water inlet pipe and loosely fit the Tempering valve cold inlet fitting.

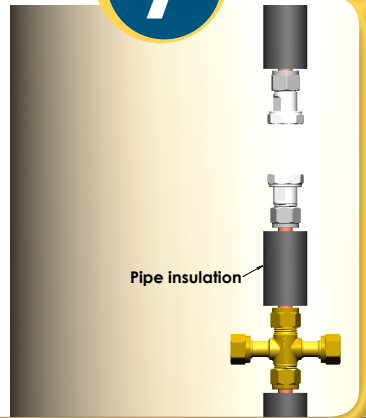

8

Slide the Tempering valve back into position making sure that the sealing "O" rings are in position and tighten the loose nuts to secure. Now tighten the connection to the cold water inlet fitting to the Tempering valve and ensure all connections are tightened.

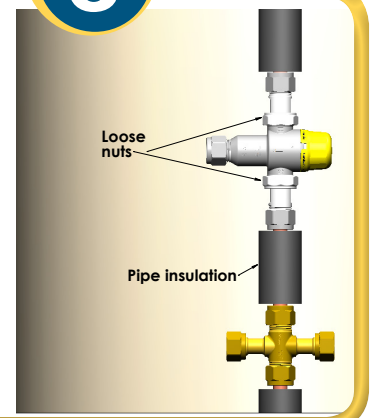

9

Fit the NRIBVS to the raised cross loose nut making sure that the sealing washer is in place and tighten. NB: Some installations require an NRI-PRV in place of the NRIBVS as shown below.

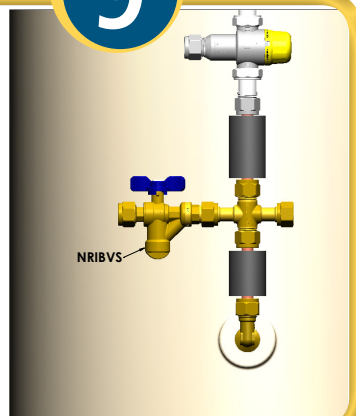
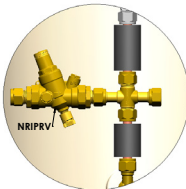

10

Fit the ECV to the raised cross loose nut making sure that the sealing washer is in place and tighten.

(For installations not requiring an ECV fit the optional sealing plug)

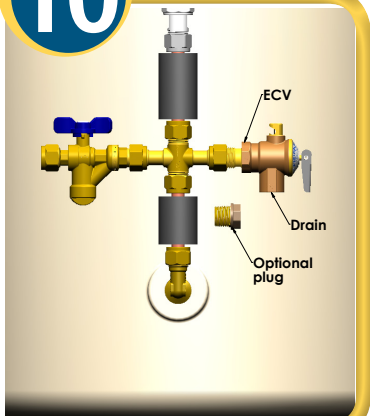

11

IMPORTANT NOTE: Flush lines before connecting pipework. Fit the insulation to the cold water and mixed water pipework then connect the pipework to the inlet of the NRIBVS and the mixed water outlet of the Tempering valve, tighten and check all joints for leaks.

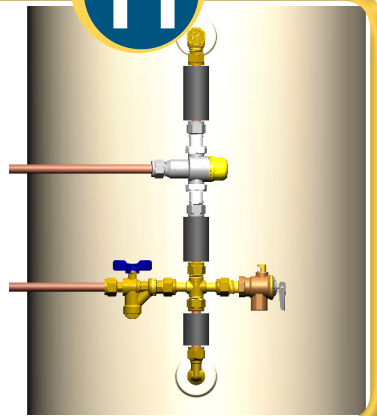

12

Fit the insulation gloves using the cable ties provided to secure in place. Trim the cable tie to length and position the cable locks away from view by rotating the cable tie around the insulation glove.

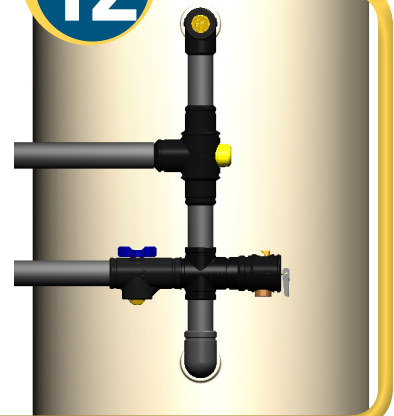

Raised Quick Installation Kits

Quickie **RAISED R**



AVG WA (Head Office)
Unit 2, 9-11 Noble St,
Kewdale WA 6105
Fax: (08) 9353 2689
Tel: 1800 AVG AUS (284 287)

AVG VIC
Factory 14/58 Mahoneys Rd,
Thomastown, VIC 3074
Tel: (03) 9462 2666
Fax: (03) 9462 3888

